

## Dexter WCAD20KCS-12 (T300) Loading Door Hinge

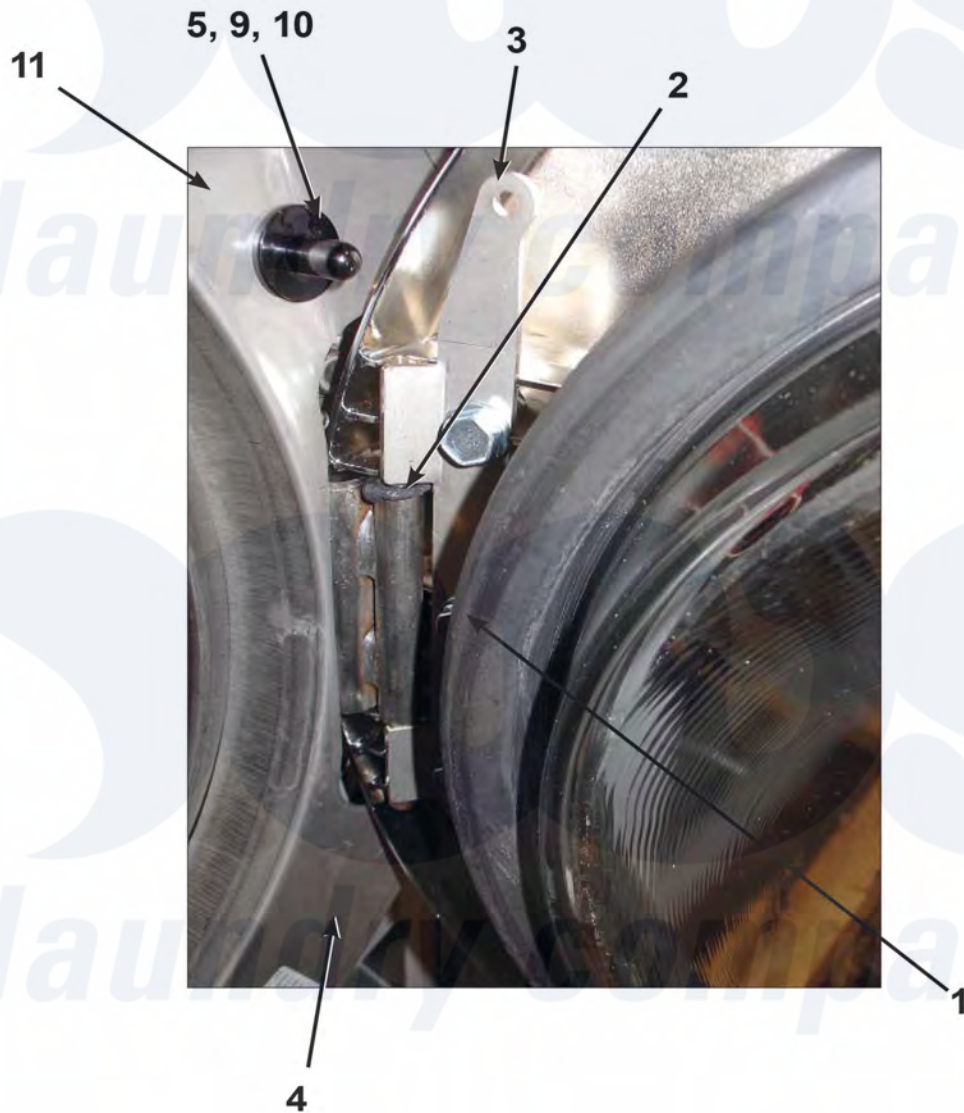

Dexter [Commercial Dexter WCAD20KCS-12 \(T300\) Washer Parts](#) Parts Diagram Loading Door Hinge  
 Click on the part number to view part

Item	Original Part Number	Replaced By	Status	Part Description
1	<a href="#">9955-029-002</a>			Door Hinge Assembly Mounts to Tub Front
2	<a href="#">9781-001-001</a>			Loading Door Hinge Pin
3	<a href="#">9079-122-003</a>			Loading Door Hinge Clamp (No Hinge Switch Pin) (NEW Style)
4	9487-272-001		Not Available	Masking Ring Assembly (For Newer Plunger Switch)
5	<a href="#">8220-063-025</a>			Wire Assembly Door Close Switch, Red 17"
9	<a href="#">8220-063-026</a>			Wire Assembly Door Close Switch, BLK 17"
10	<a href="#">9539-492-001</a>			Switch, Door closed Switch (Push Button style)
11	9487-272-001		Not Available	Masking Ring Assembly (For

**WWS**  
*the laundry company*<sup>®</sup>

**WWS**  
*the laundry company*<sup>®</sup>

**WWS**  
*the laundry company*<sup>®</sup>