

Maytag MFS80PNAVS 14 - CONTROL PANEL

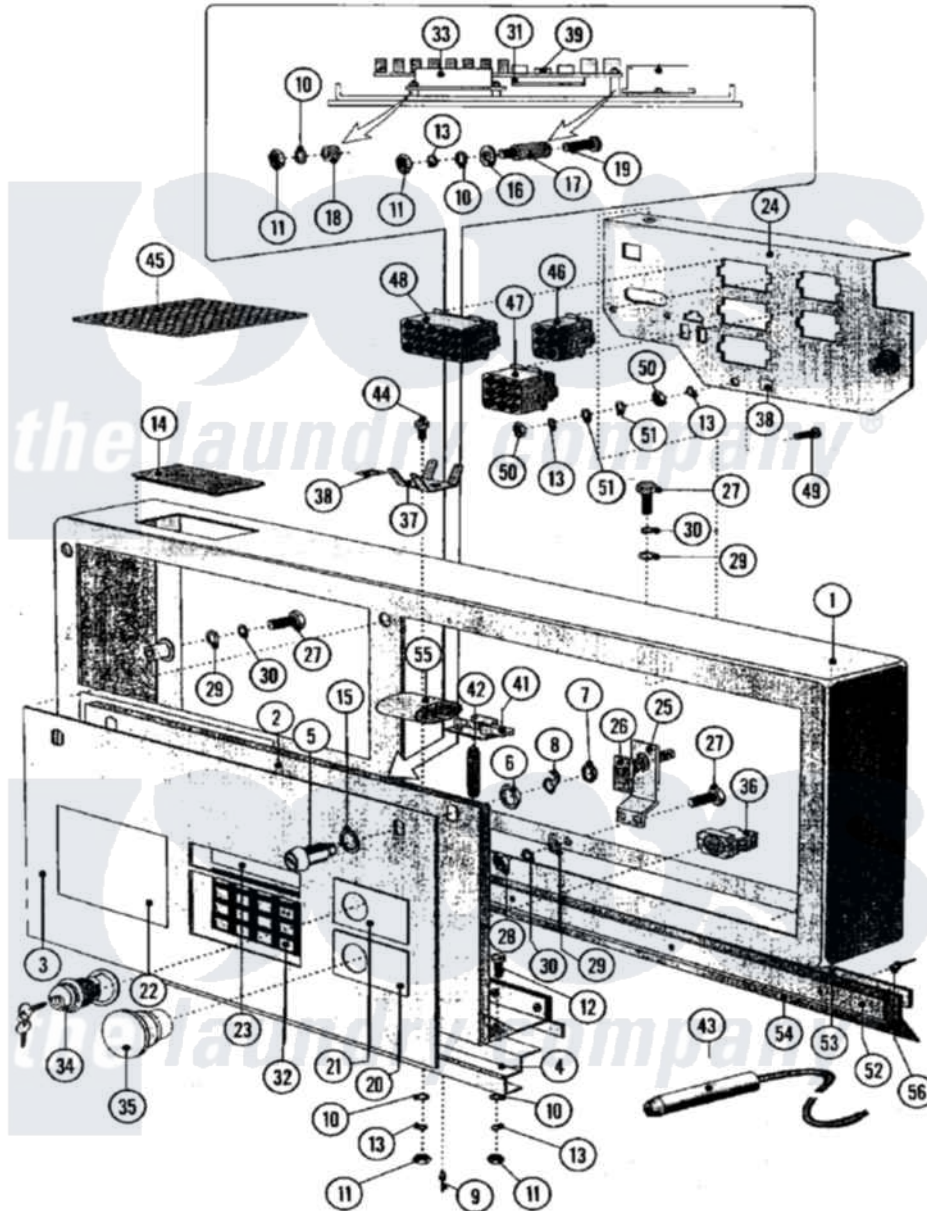

Maytag Commercial Maytag MFS80PNAVS Washer Parts Parts Diagram 14 - CONTROL PANEL
 Click on the part number to view part

| Item | Original Part Number | Replaced By | Status | Part Description |
|------|--------------------------|--------------------------|---------------|-----------------------|
| 001 | 23002763 | | | Panel, Front |
| 002 | 23003233 | | | Cover, Top |
| 003 | 23002765 | | | Plate, Index |
| 004 | 23002766 | | | Support, Plate |
| 005 | 23001583 | | | Device, Locking |
| 006 | 23001008 | | | Nut, Lock |
| 007 | 23001011 | | | Nut |
| 008 | 23002451 | | | Pawl |
| 009 | NLA | | Not Available | RIVET/CRANK (4 X 7.5) |
| 010 | 23001610 | 23002438 | | Washer M4.3 |
| 011 | 23002399 | 23001014 | | Nut M4 |
| 012 | 23002423 | 23001361 | | Bolt |
| 013 | 23002400 | | | Washer |
| 014 | NLA | | Not Available | COVER |
| 015 | 23001007 | | | Washer M21x27x1 |
| 016 | NLA | | Not Available | INSULATION (WASHER) |

| | | | | |
|-----|--------------------------|--------------------------|---------------|--------------------------------|
| 017 | NLA | | Not Available | INSULATION (BOARD SUPPORT) |
| 018 | 23001058 | | | Tube, Distance |
| 019 | 23002769 | | | Screw |
| 020 | NLA | | Not Available | LABEL, EMERGENCY STOP |
| 021 | NLA | | Not Available | PLATE (HOPPERS-PUMPS) |
| 022 | NLA | | Not Available | LABEL, PROGRAM |
| 023 | 23002163 | | | Hole, Inspection |
| 024 | 23002773 | | | Bracket, Terminal Board |
| 025 | 23002774 | | | Holder, Vibration Switch |
| 026 | 23002775 | | | Switch, Vibration |
| 027 | NLA | | Not Available | SCREW (M6X10) |
| 028 | 23002651 | 23001312 | | Mut M6 |
| 029 | 23002282 | 23001027 | | Washer |
| 030 | 23002357 | 23002440 | | Washer, Spring Lock |
| 031 | 23002949 | 23002201 | | Microprocessor |
| 032 | 23001692 | | | Keyboard |
| 033 | 23001718 | | | Board, Additional |
| 034 | BLANK | | Not Available | SWITCH |
| 035 | 23001078 | 23002331 | | Contactor, Central Stop |
| 036 | 23001075 | 23002331 | | Contactor, Central Stop |
| 037 | NLA | | Not Available | CONTACT (6.3 TYPE 140609-0) |
| 038 | NLA | | Not Available | LABEL, EARTH |
| 039 | 23003744 | 23003745 | | Controller, Apl280ne V1.04 |
| " | 23003745 | | | Controller, Apl280ne V1.04 |
| 040 | 23002025 | | | Label, Electrostatic Sensitive |
| 041 | 23001094 | | | Bridge, Rectifier |
| 042 | 23001099 | | | Socket, Pc Board Socket |
| 043 | 23001073 | | | Sensor, Temperature |
| 044 | 23001609 | 23002721 | | Screw |
| 045 | NLA | | Not Available | LABELS, DESCRIPTION |
| 046 | 23001723 | | | Board, Terminal |
| 047 | 23001722 | | | Board, Terminal |
| 048 | 23001721 | | | Board, Terminal |
| 049 | 23002778 | | | Screw |
| 050 | NLA | | Not Available | NUT (M4) |
| 051 | 23002725 | | | Washer |
| 052 | NLA | | Not Available | BAR |
| 053 | NLA | | Not Available | STRIP |
| 054 | 23002782 | | | Top Cuff |
| 055 | 23002408 | | | Rivet W/Crank |
| 056 | 23002219 | | | Device, Operating |

the laundry company®